

KASTRUP SEA BATH
WHITE ARKITEKTEN
KØBNHAVN, DANMARK





PROJECT COMPONENTS

The project is comprised of the main structure, out on the water. There is a service building which includes lavatories and changing rooms. The beach area has also been redesigned in a masterplan that works in concert with the hardscape.



PROJECT INFO

The project extends into the Øresund from the beach in the Kastrup neighborhood in København, Denmark. The project is free and open to the public at all times. An important concept was that young, middle aged, and elderly would all be equally comfortable in this space.

SITE PLAN

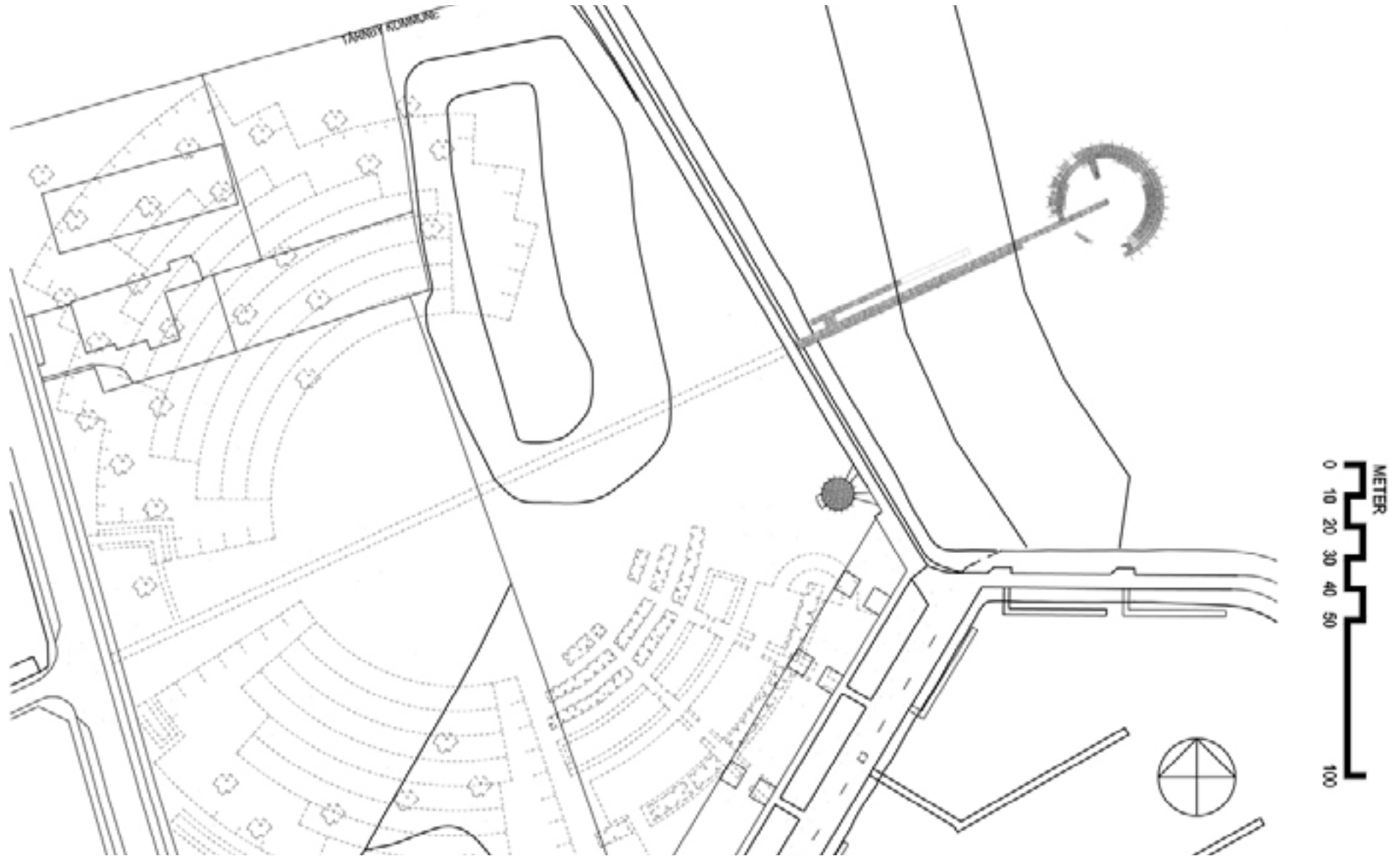

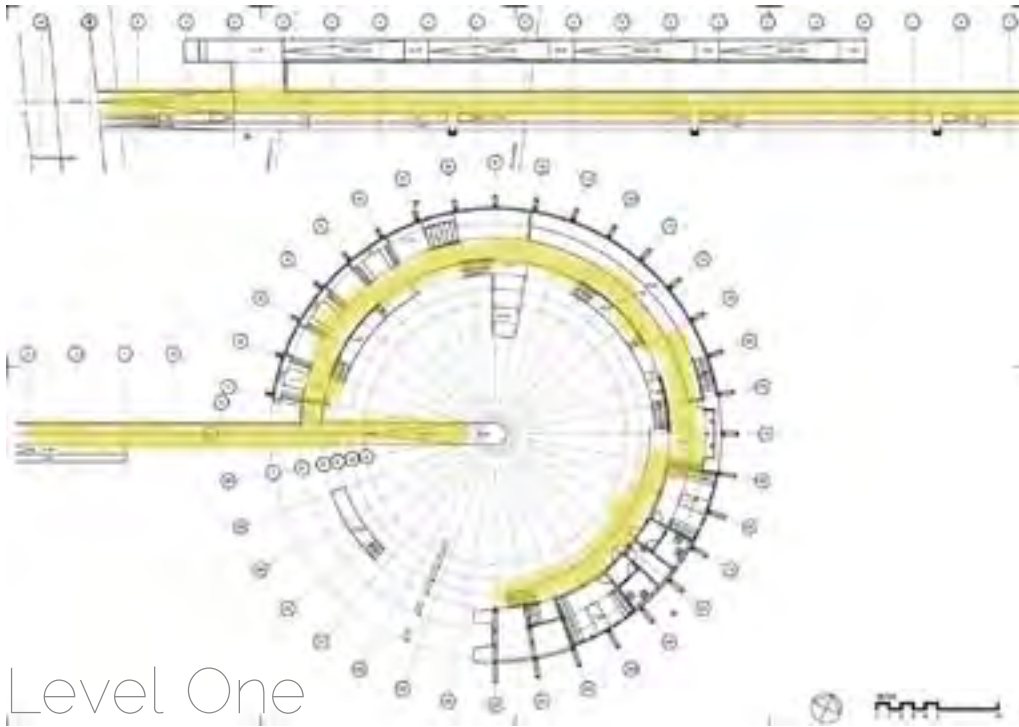

Level One

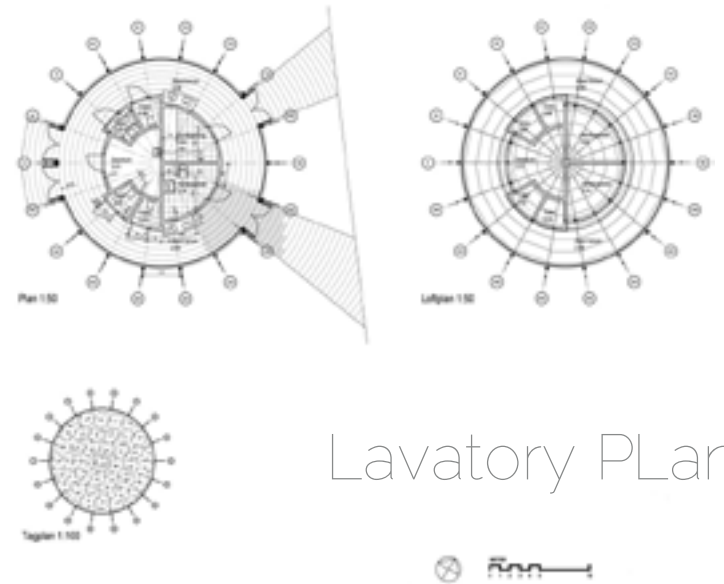

Lavatory Plan

Boardwalk Detail

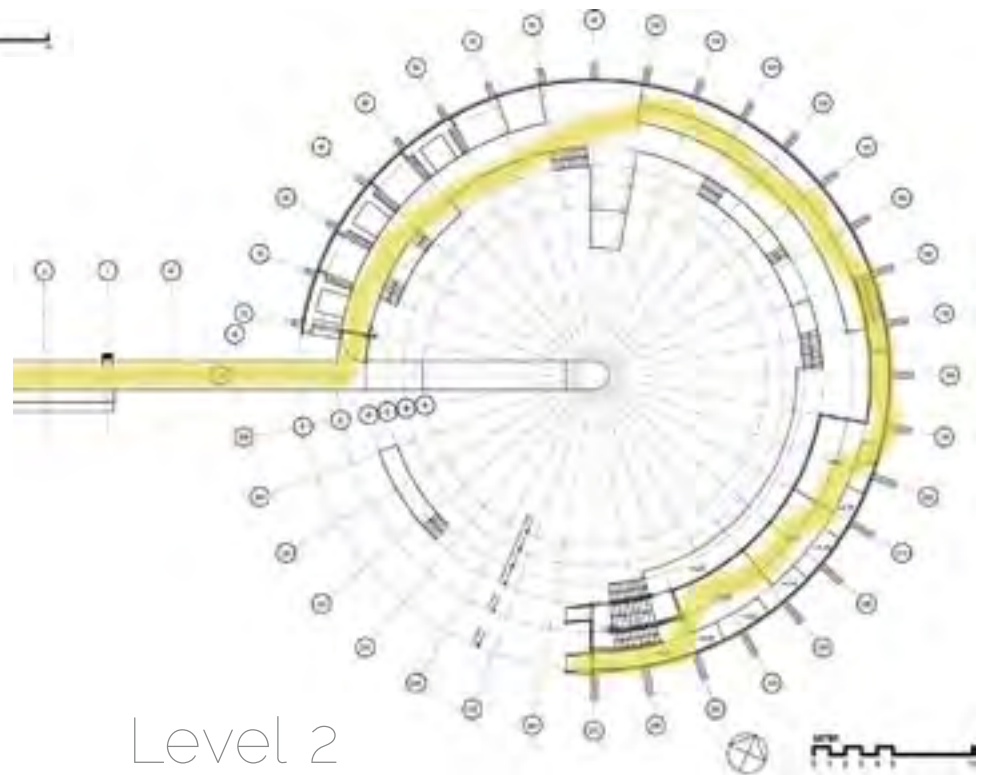
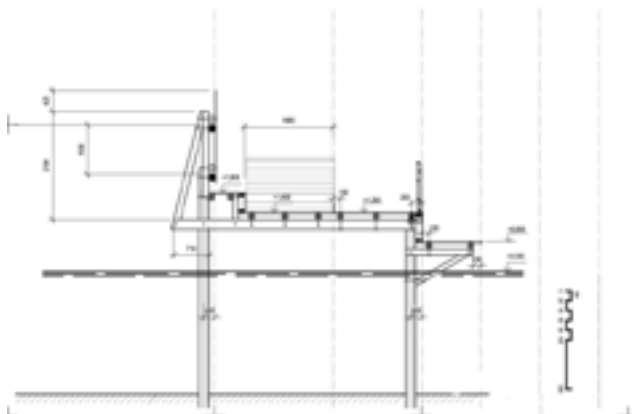

Level 2

Long Section

